

**FSG (Coaxial+Low Voltage), Fixed Socket, Key(G)**

- Connector series: FSG
- Contact: Female
- Locking type: Self-locking
- Orientation type: Straight
- Part No.: FSG.2B.810.CLL
- Mated with: PSG series

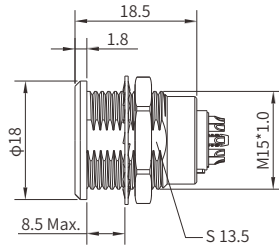

**General Information**

Ambient temperature:	-55°C ~ + 250°C
Endurance:	>5000 cycles
Insulator:	PEEK
Connector contacts:	Brass with gold plated

Housing:	Brass with Cr plated
IP rating:	IP50
Shielding efficiency:	at 10MHz>75dB/at 1GHz>40dB
Salt spray corrosion test:	>144h

Impedance(O)	Coaxial					Low voltage			
	φB(mm) Min.	φB(mm) Max.	Cable OD(mm) Max.	VSWR (f=GHZ)	Cable standard	φA(mm)	Contanct type	Rated voltage (KV)	Rated current (A)
50	0.50	0.58	1.65	1.04+0.1f	RG178 B/U	0.70	Solder	0.3	7

Panel cut-out (page 164)

**FSG Fixed Socket, Multi Coaxial or Fluidic Contact Mixed + LV , Key(G) or Keys(A...F and R)**

- Connector series: FSG
- Contact: Female(Mixed)
- Locking type: Self locking
- Orientation type: Socket
- Part No.:FSG.3B.8xx.CLL
- Mated with: PSG/PLG/MSG

Note: Fluid contact is type P1 , see page 150

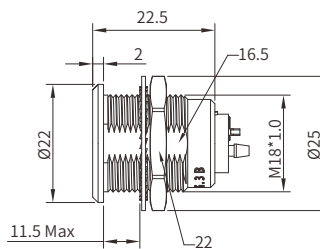

**General Information**

Ambient temperature:	-55°C ~ + 250 °C (Fluidic -20°C ~ + 125°C)
Endurance:	>3000 cycles (Fluidic>1000 cycles)
Insulator:	PEEK
Connector contacts:	Brass with gold plated
Housing:	Brass with Cr plated

O-ring:	FPM
Insulator resistance:	≥100MΩ
IP rating:	IP 50
Shielding efficiency:	at 10MHz>75dB/at 1GHz>40dB
Salt spray corrosion test:	>144h

NO	Coaxial/Fluidic <sup>1)</sup>			LV					
	Contact quality	Impedance	Contact quality	φA(mm)	Contact type	Test Voltage (Kv rms)	Test voltage (Kv DC)	Rated current (A)	
846	2	50Ω/-	6	0.9	Solder	0.9	1.3	10	
862	3	50Ω/-	2	0.9	Solder	1.10	1.60	9	

1):Coaxial and fluid can be used interchangeably